

system GREY

G-10

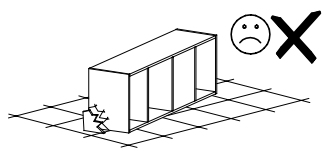

Narzędzia potrzebne do montażu

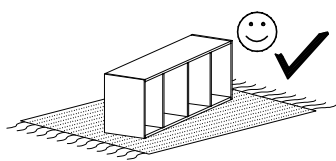
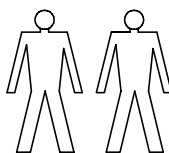
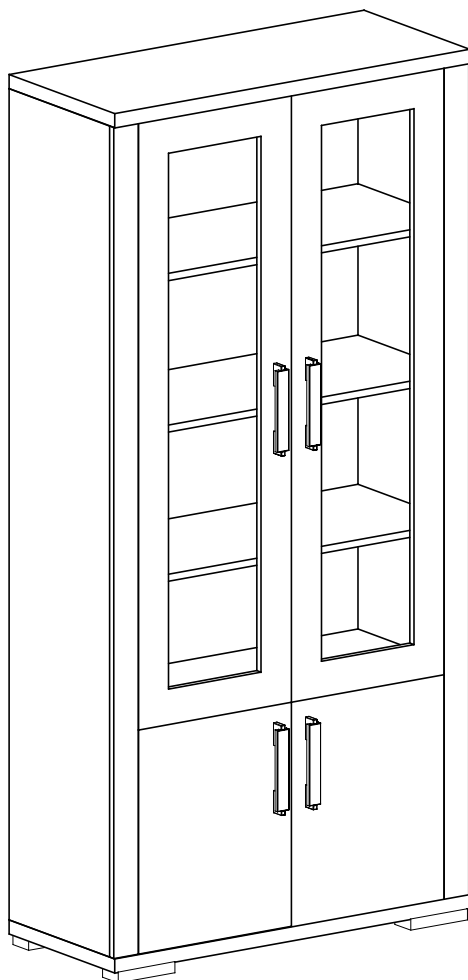
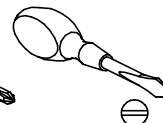
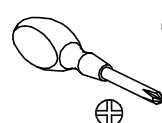
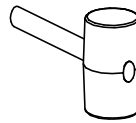
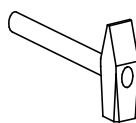

R-2 St.



S-8 St.
4x27

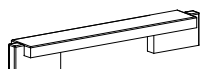

U-4 St.

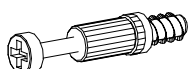

N-20 St.

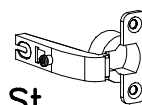

D-10 St.

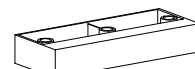

A-2 St.



E-60 St.

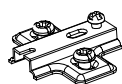

C-10 St.

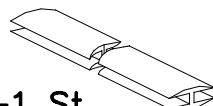

H-1 St.



P2-4 St.

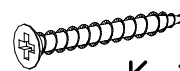

K-10 St.
4x30



P1-12 St.

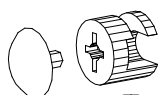

T-20 St.

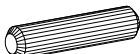

B-22 St.

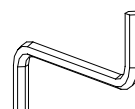

Y-1 St.



Z-20 St.
3,5x16

I

